



Agenda

2011 CEDAR-GEM Joint Workshop
Theme: Exploring Connections in the Geospace System

<p align="center">Sunday 26 June CEDAR-GEM Joint Student Workshop (Students ONLY!) Theme - Magnetosphere-Ionosphere (MI) Coupling Co-Chairs: CEDAR: Roger Varney (Cornell) and Elizabeth Bass (BU); GEM: Brian Walsh (BU) and Jenni Kissinger (UCLA)</p>		
0800-0900	Breakfast Eldorado Pavilion	
0800-0900	Registration in Hall, Sign Travel Vouchers Eldorado Hallway	
0900-0915	What is CEDAR? Eldorado Anasazi Ballroom	Roger Varney (Cornell)
0915-0930	What is GEM?	Jenni Kissinger (UCLA)
0930-0950	Introduction to the Magnetosphere	Katelynn Greer (U CO)
0950-1010	Introduction to the Ionosphere	Julie Feldt (U Mich)
1010-1030	Geomagnetism and Geomagnetic Indices	Matina Gkioulidou (UCLA)
1030-1050	<i>Break</i>	
1050-1110	High Latitude Electrodynamics	Nathaniel Frissell (VT)
1110-1130	Convection in the Ionosphere and Magnetosphere	Feifei Jiang (UCLA)
1130-1150	Aurora: Magnetospheric View	Christine Gabrielse (UCLA)
1150-1210	Aurora: Ionospheric View	Carl Andersen (UAF)
1210-1330	Pizza Lunch for the students Eldorado Pavilion	
1330-1350	Geomagnetic Storms	Lauren Blum (U CO)
1350-1410	Ion Outflow	Robert Redmon (U CO)
1410-1430	Applications of Incoherent Scatter Radar to MI Coupling	Hassanali Akbari (BU)
1430-1450	Introduction to Sounding Rockets	Stephen Kaepler (U Iowa)
1450-1510	<i>Break</i>	
1510-1530	CubeSats	Alex Crew (UNH)
1530-1540	Ionospheric Models	Levan Lomidze (USU)
1540-1550	GEM Models	Matt Gibson (UNH)
1550-1610	Student Welcome from GEM and CEDAR Chairs	Liemohn/Foster/Sibeck
16:10	<i>Adjourn</i>	
1610-1900	Free time for student recreation (Annual CEDAR Soccer Game, Ultimate Frisbee; etc) ALTERNATE SCHEDULE for Sunday	Mager's Field (490 Bishops Lodge Road) See Attached Map for Directions
0900-1800	Response of the Magnetosphere to High-Speed Streams Eldorado Sunset	Sign up via GEM registration or if CEDAR, contact Mike Liemohn if attending this LWS meeting
1830-2200	Dinner on your own at area restaurants or CEDAR Science Steering Committee Dinner/Meeting	

Monday 27 June Santa Fe Convention Center		
0715-0800	Breakfast Eldorado Pavilion	
0715-0800	Registration Santa Fe Convention Center (SFCC) Hallway	
0800-0815	Welcome from NSF/CSSC-GEM SFCC E+F Ballroom (large plenary room)	Richard Behnke (NSF)/John Foster (CSSC)/Michael Liemohn (GEM)
0815-0825	Introduction of CEDAR and GEM students by institution SFCC E+F Ballroom	CEDAR and GEM Student Representatives
0825-0830	Introduction of CEDAR and GEM Postdocs SFCC E+F Ballroom	Richard Behnke (NSF)
0830-0900	NSF Geospace Section Updates SFCC E+F Ballroom	Richard Behnke/Farzad Kamalabadi (NSF)
0900-0930	<i>Break</i>	
0930-1005	Science Imperatives for Atmosphere-Ionosphere-Magnetosphere Interactions (15 min discussion) SFCC E+F Ballroom	Jeffrey Forbes (U CO)
1005-1040	Science Imperatives for Solar-Wind-Magnetosphere Interactions (15 min discussion) SFCC E+F Ballroom	Michelle Thomsen (LANL)
1040-1120	Outflow and Mass Flow (IT and MAG perspectives) SFCC E+F Ballroom	Robert Schunk (USU) and William Lotko (Dartmouth)
1120-1200	Inner Magnetosphere-Ionosphere Coupling (with IT and MAG perspectives) SFCC E+F Ballroom	Mark Moldwin (UCLA) and Pontus Brandt (APL/JHU)
1200-1330	<i>Lunch on own</i>	
1330-1530	JOINT Student Tutorial/Workshop on Data Assimilation Eldorado Anasazi Ballroom	Matsuo/Knipp/Richmond
	JOINT Measurements of Ion Outflow SFCC Coronado+DeVargas	Chappell/Schunk/Welling
	JOINT MI Coupling at Middle and Low Latitudes SFCC O'Keefe+Milagro	Fejer/Immel/Maruyama/Sazykin
	CEDAR Coupling Between the Lower and Upper Atmosphere During Extreme Meteorological Events Eldorado Sunset	Goncharenko/Chau/Chandran
	GEM Plasma and Energy Transport (summary) SFCC Peralta+Lamy	Otto/Johnson/Wing
	GEM K Magnetospheric Response Modes SFCC Kearney	Kepko/McPherron
	GEM Radiation Belts Eldorado Zia	Shprits/Elkington/Bortnik/Kletzing
1530-1600	<i>Break</i>	
1600-1800	JOINT Modeling Ionospheric Outflow SFCC Coronado+DeVargas	Schunk/Chappell/Welling
	JOINT GPS Observations and Tools SFCC Peralta+Lamy	Bust/Murr/Dyrud
	JOINT Nonlinear Plasma Effects SFCC Kearney	Mishin/Streltsov
	CEDAR Coupling Between the Lower and Upper Atmosphere During Extreme Meteorological Events Eldorado Sunset	Goncharenko/Chau/Chandran
	CEDAR Joint Low-latitude Ionospheric Sensor Network (LISN) and Jicamarca Eldorado Anasazi Ballroom	Valladares/Hysell/Chau
	GEM Plasma and Energy Transport (planning/future vision) SFCC Peralta+Lamy	Otto/Johnson/Wing
	GEM PLAsmasphere-Magnetosphere Interactions SFCC O'Keefe+Milagro	Goldstein/Spasojevic/Borovsky
	GEM Radiation Belts Eldorado Zia	Shprits/Elkington/Bortnik/Kletzing
1830	Cash bar and HooDoos band SFCC Sweeney Ballroom	
1915-1930	Start of plated banquet SFCC Sweeney Ballroom	

2015 - 2030	Keynote Speaker: A Remembrance of Sendai, Japan, March 2011	Michael Mendillo (BU)
2200	End of joint banquet	
Tuesday 28 June Santa Fe Convention Center		
0715-0800	Breakfast Eldorado Pavilion	
0715-0800	Registration SFCC Hallway	
0800-0930	GEM Plenary: Magnetosheath: A Wonderful Laboratory for the Investigation of Fundamental Plasma Processes Eldorado Anasazi Ballroom	Tai Pahn (UCB)
	GEM Plenary: Magnetospheric Response Modes: Methods of Identification Eldorado Anasazi Ballroom	Robert Weigel (GMU)
ALTERNATE SCHEDULE for Tuesday		
0800-0845	CEDAR Plenary Prize Lecture: Modeling Global Ionospheric Phenomena (e.g., Equatorial Bubbles) SFCC E+F Ballroom (large plenary room)	Joseph Huba (NRL)
0845-0905	CEDAR Plenary Science Highlight: Exploring Local-Scale Flow Structures in Thermospheric Winds using a Bistatic Array of All-sky Imaging Fabry-Perot Spectrometers SFCC E+F Ballroom	Callum Anderson (U AK)
0905-0920	CEDAR Plenary Final Post-Doc Report: A Study of Polar Mesospheric Cloud Structures and the Environment in Which They Form SFCC E+F Ballroom	Brentha Thurairajah (VT)
0920-0930	CSSC Announcements SFCC E+F Ballroom	John Foster/NSF
0930-1000	<i>Break (put up posters for Tuesday poster session)</i>	
1000-1200	JOINT Dayside FACs and Energy Deposition Eldorado Anasazi Ballroom	Crowley/Knipp/Eriksson/Carlson
	JOINT GPS Observations and Tools SFCC Peralta+Lamy	Bust/Murr/Dyrud
	JOINT Nonlinear Plasma Effects SFCC Kearney	Mishin/Streltsov
	CEDAR Theoretical and Experimental Studies of the Low-Latitude Thermosphere-Ionosphere System Eldorado Sunset	Rodrigues/de la Beujardiere/Makela/Lu
	CEDAR Lightning Effects on the Upper Atmosphere SFCC C Ballroom	N Liu/Stanley/Taylor
	GEM Magnetosheath SFCC Coronado+DeVargas	Nykyri/Petrinec
	GEM PLAsmasphere-Magnetosphere Interactions SFCC O'Keefe+Milagro	Goldstein/Spasojevic/Borovsky
1200-1330	<i>Lunch on own</i>	
1330-1530	JOINT Dayside FACs and Energy Deposition Eldorado Anasazi Ballroom	Crowley/Knipp/Eriksson/Carlson
	JOINT MI Coupling in the PBL SFCC Coronado+DeVargas	Erickson/Goldstein
	JOINT Climatology Modeling Challenge SFCC O'Keefe+Milagro	Emery/Guild
	CEDAR Low Latitude Spread F Studies Eldorado Sunset	Rodrigues/de la Beujardiere/Makela/Lu
	CEDAR Recent Thermospheric Wind Measurements From Ground-based Instrumentation and Associated Modeling Efforts SFCC C Ballroom	Gerrard/Makela/Meriwether/Ridley/Conde/Wu
	GEM Pre-focus Group Planning for Magnetic Reconnection SFCC Peralta+Lamy	Sullivan
	GEM Near Earth Magnetosphere SFCC Kearney	Zaharia/Sayzykin/Lavraud
1530-1600	<i>Break</i>	

1600-1900	CEDAR MLT and GEM Poster Sessions SFCC Sweeney A & B (light snacks)	
Wednesday 29 June Santa Fe Convention Center		
0715-0800	Breakfast Eldorado Pavilion	
0715-0800	Registration (take down #1 session posters) SFCC Hallway	
0800-0930	JOINT Plenary on System Science SFCC E+F Ballroom (large plenary room)	Joshua Semeter and William Lotko moderators
	CEDAR Strategic Planning Document	Jeffrey Thayer (U CO)
	System Science Theory	David Hysell (Cornell)
	Atmosphere-Ionosphere-Magnetosphere System Science	Thomas Immel (UC Berkeley)
	Solar-Wind-Magnetosphere-Ionosphere System Science	Michael Liemohn (U MI)
	Wrap-up	Joshua Semeter (BU) and William Lotko (Dartmouth)
0930-1000	<i>Break (take down Tuesday's posters and put up posters for Wednesday's session)</i>	
1000-1200	JOINT Thermosphere-Ionosphere-Electrodynamics General Circulation Model Working Group SFCC Coronado+DeVargas	Solomon/Wiltberger/Foster
	JOINT Nightside Multi-Scale MIT Coupling Eldorado Anasazi Ballroom	Nicolls/Zou/Lyons
	GEM Merging Outflow and GGCM Models SFCC D Ballroom	Welling/Schunk/Chappell
	CEDAR World Day Planning SFCC Kearney	Haggstrom/McCready
	CEDAR Recent Thermospheric Wind Measurements From Ground-based Instrumentation and Associated Modeling Efforts SFCC C Ballroom	Gerrard/Makela/Meriwether/Ridley/Cond e/Wu
	GEM Diffuse Aurora Eldorado Sunset	Samara/Michell
	GEM Space Radiation Climatology SFCC O'Keefe+Milagro	O'Brien/Reeves
		<i>Lunch on own</i>
1330-1530	JOINT Coupled Magnetosphere-Ionosphere-Thermosphere Model Working Group SFCC Coronado+DeVargas	Wiltberger/Solomon/Foster
	JOINT CubeSats for GEM and CEDAR Science SFCC Peralta+Lamy	GSwenson/Klumpar/Lynch/Moretto-Jorgensen/Doe/CSwenson/Lin/Earle
	JOINT Nightside Multi-Scale MIT Coupling Eldorado Anasazi Ballroom	Nicolls/Zou/Lyons
	GEM Outflow Modeling, Measuring, and Merging Planning Session SFCC D Ballroom	Welling/Chappell/Schunk
	CEDAR Arecibo Friends SFCC C Ballroom	Gonzalez
	GEM Near Earth Magnetosphere SFCC Kearney	Zaharia/Sayzykin/Lavraud
	GEM Diffuse Aurora Eldorado Sunset	Samara/Michell
	GEM Space Radiation Climatology SFCC O'Keefe+Milagro	O'Brien/Reeves
1530-1600	<i>Break</i>	
1600-1900	Joint CEDAR IT and GEM Poster Sessions SFCC Sweeney A & B (light snacks)	
Thursday 30 June Santa Fe Convention Center		
0715-0800	Breakfast Eldorado Pavilion	
0715-0800	Registration (take down posters) SFCC Hallway	

0800-0845	JOINT Plenary Student Chosen Tutorial: Using GPS to Study Magnetospheric-Ionospheric Coupling SFCC E+F Ballroom (large plenary room)	Anthea Coster (MIT)
0845-0905	Radiation Belt Storm Probes (RBSP) Mission - Opportunities for Joint Research with CEDAR and GEM SFCC E+F Ballroom	Joseph Grebowsky (GSFC)
0905-0925	The Future of Space Weather Modeling (title TBD) SFCC E+F Ballroom	Stanley Solomon (NCAR)
0925-0935	Announcement of CEDAR Student Poster Prize Winners SFCC E+F Ballroom	Mark Conde (U AK)
0935-1000	<i>Break</i> <i>(all posters come down and student winning posters put up in E+F Sweeney)</i>	
1000-1200	JOINT Modeling Challenge Comparisons Eldorado Anasazi Ballroom	Shim/Kuznetsova/Emery/Ridley/ Knipp/Fuller-Rowell/Guild/Sojka
	JOINT CubeSats for GEM and CEDAR Science SFCC Peralta+Lamy	GSwenson/Klumpar/Lynch/Moretto- Jorgensen/Doe/CSwenson/Lin/Earle
	JOINT Remote Sensing of the Inner Magnetosphere SFCC Coronado+DeVargas	Makarevich/Shprits
	CEDAR Meteor Science: Upper Atmospheric Impacts SFCC O'Keefe+Milagro	Fentzke/Urbina
	GEM Substorms SFCC C Ballroom	Angelopoulos/Ohtani/Shiokawa
	GEM THEMIS Software Tutorial SFCC D Ballroom	THEMIS Group
	GEM Diffuse Aurora Eldorado Sunset	Samara/Michell
1200-1330	<i>Lunch on own or CEDAR CSSC Luncheon</i>	
1330-1530	JOINT Modeling Challenge Metrics and Planning Eldorado Anasazi Ballroom	Shim/Kuznetsova/Emery/Ridley/ Knipp/Fuller-Rowell/Guild/Sojka
	JOINT High-Speed Stream Driving of Geospace SFCC Peralta+Lamy	Kozyra/Thorne
	CEDAR New Results of Lidar Observations and Studies from High to Low Latitudes SFCC O'Keefe+Milagro	Chu/Swenson
	GEM Magnetic Mapping SFCC Coronado+DeVargas	Donovan/MacDonald/Millan
	GEM Substorms SFCC C Ballroom	Angelopoulos/Ohtani/Shiokawa
	GEM Diffuse Aurora Eldorado Sunset	Samara/Michell
1530-1600	<i>Break</i>	
1600-1800	JOINT High-Speed Stream Driving of Geospace SFCC Peralta+Lamy	Kozyra/Thorne
	JOINT The Chapman Storm Auroral Events Eldorado Anasazi Ballroom	Donovan/Kieling/Bristow/Lyons/ Kepko
	CEDAR Equatorial-PRIMO (Problems Related to Ionospheric Models and Observations) SFCC O'Keefe+Milagro	Fang/Anderson
	GEM Magnetic Mapping SFCC Coronado+DeVargas	Donovan/MacDonald/Millan
	GEM Substorms SFCC C Ballroom	Angelopoulos/Ohtani/Shiokawa
	GEM Radiation Belts Eldorado Sunset	
		Shprits/Elkington/Bortnik/Kletzing
Friday 01 July Santa Fe Convention Center		
0715-0800	Breakfast Eldorado Pavilion	
0715-0800	Registration SFCC Hallway	

0815-1000	GEM Plenary: How to Model Micro-Macro Coupling: Magnetic Reconnection SFCC E+F Ballroom (large plenary room)	Michael Hesse (CCMC/GSFC)
	GEM Plenary: The Plasmasphere: Diagnostics and Modeling and Why We Should Care SFCC E+F Ballroom	Richard Denton (Dartmouth)
1000-1015	<i>Break</i>	
1015-1215	CEDAR Ionospheric Data Assimilation: Current Status and Future Plans SFCC Peralta+Lamy	Bust/Pi/Data-Barua
	CEDAR Using, Administering, and Submitting Data to the VSTO and Madrigal Databases within the CEDAR Community SFCC Kearney	Emery/Rideout
	GEM Magnetic Mapping SFCC Coronado+DeVargas	Donovan/MacDonald/Millan
	GEM Substorms SFCC C Ballroom	Angelopoulos/Ohtani/Shiokawa
	GEM Radiation Belts Eldorado Sunset	Shprits/Elkington/Bortnik/Kletzing
1215	<i>Adjourn CEDAR</i>	
1215-1330	GEM Focus Group Reports (wrap-up, no CEDAR scheduled) Eldorado Anasazi	
1330	Adjourn GEM	
1345-1600	GEM Steering Committee Meeting Eldorado Sunset	

Santa Fe Convention Center Room Layouts

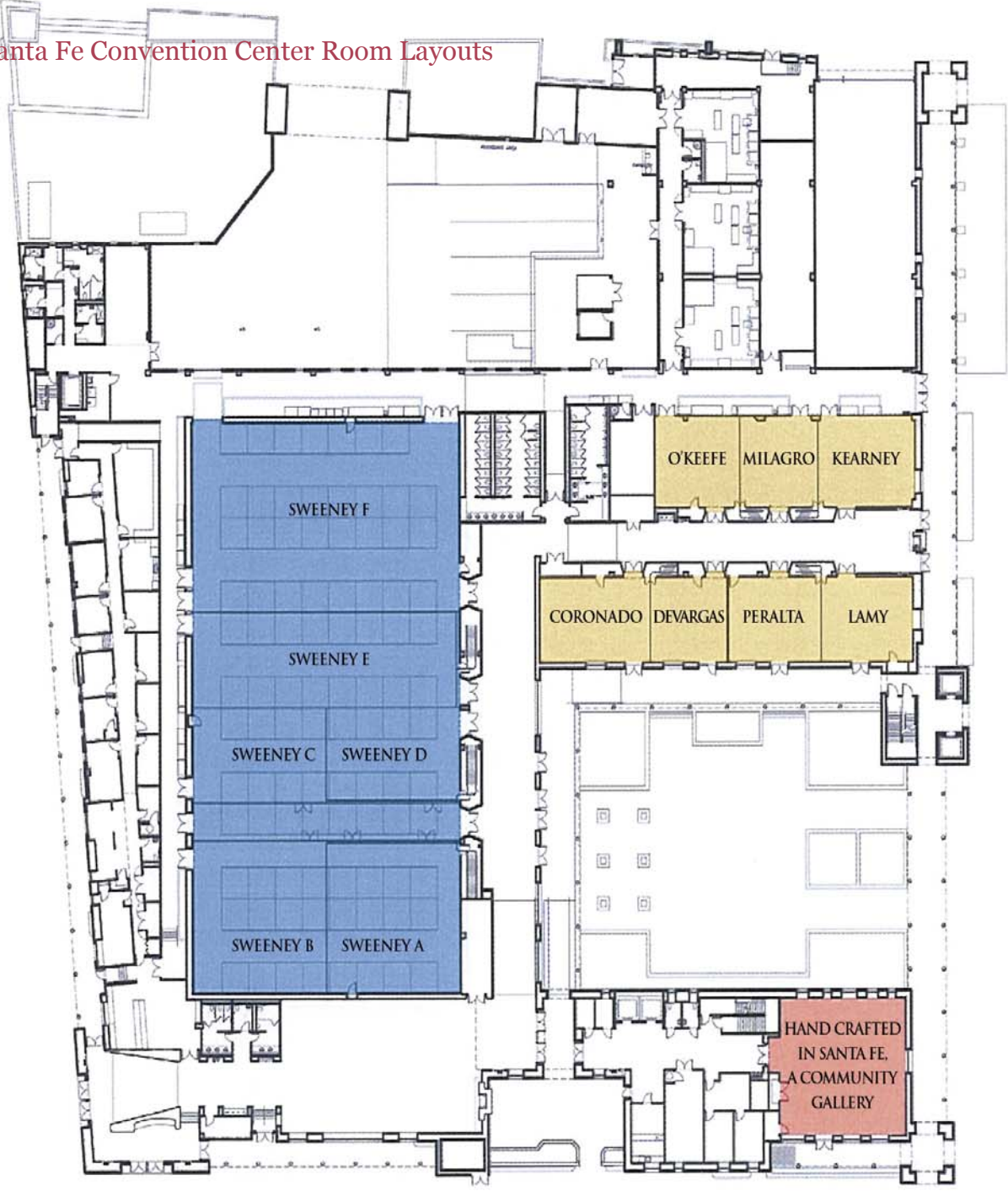

FIRST LEVEL

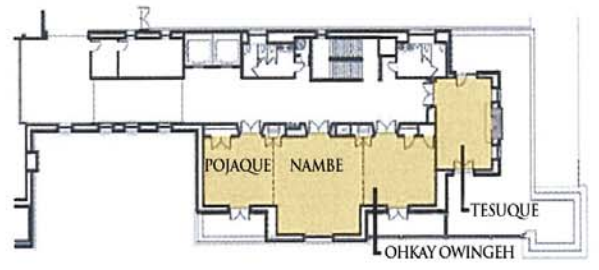
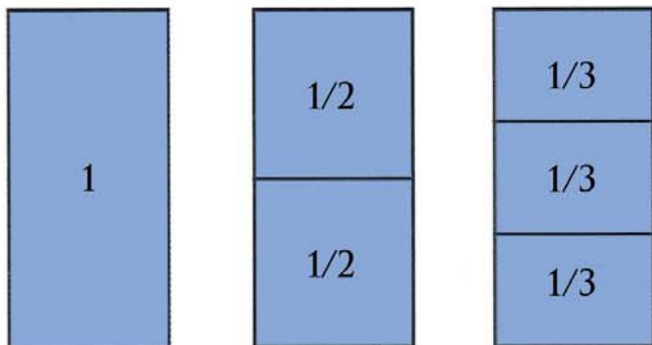

SECOND LEVEL

El Dorado Room Layouts

